



**SOUTH FLORIDA WATER MANAGEMENT DISTRICT**

LOWER WEST COAST REGIONAL SERVICE CENTER 2301 McGregor Boulevard, Fort Myers, FL 33901  
(239) 338-2929 • FL WATS 1-800-248-1201 • Suncom 748-2929 • Fax (239) 338-2936 • www.sfwmd.gov/lwc/

CON 24-06

**Application No.:** 080617-17

July 17, 2008

HENDRY COUNTY  
PO BOX 2340  
LABELLE, FL 33975

Dear Permittee:

**SUBJECT: Permit No.:** 26-00096-W  
**Project:** PORT LABELLE UTILITIES SOUTH WELL  
**Location:** HENDRY COUNTY S1,10-15/T43S/R29E  
S6,7,18/T43S/R31E  
S1,6-8,12,18,21-23,26-29/T43S/R30E  
**Permittee:** HENDRY COUNTY

District staff has reviewed the information submitted in support of the referenced application for permit modification(s) and determined that the proposed activities are in compliance with the previous permit and the appropriate provisions of Rule 40E-2.331 (4)(a), Florida Administrative Code. The permit modification(s) include the following:

This letter modification is to approve the new location approximately 55 feet to the west and construction details of the south well at the Port of LaBelle Utilities water treatment plant. The construction details of the new well and location are shown in Exhibits 1 and 2. This letter modification does not approve the increase in allocation, which is currently being reviewed under application (071115-18). This modification does not approve the increased pumping rate as requested in that application either. This modification solely approves the construction of a new well and requires the abandonment of the old south well, due to deterioration of the old well.

Please understand that your permit remains subject to the 26 Limiting Conditions and all other terms of the permit authorization as previously issued.

Sincerely,

Craig Boomgaard, P.G.  
Acting Supervisor  
Water Use Regulation Division

CB /cb

**RECEIVED**

JUL 21 2008

BY:

RF

## Limiting Conditions

- 1 If at any time there is an indication that the well casing, valves, or controls leak or have become inoperative, repairs or replacement shall be made to restore the system to an operating condition. Failure to make such repairs shall be cause for filling and abandoning the well, in accordance with procedures outlined in Chapters 40E-3 and 40E-30, Florida Administrative Code.
- 2 Permittee shall secure a well construction permit prior to construction, repair, or abandonment of all wells, as described in Chapters 40E-3 and 40E-30, Florida Administrative Code.
- 3 Every five years from the date of Permit issuance, the Permittee shall submit re-calibration data on each water pumping accounting facility, for those Permittees whose accounting method(s) require re-calibration.
- 4 The Permittee shall notify the District within 30 days of any change in service area boundary. If the Permittee will not serve a new demand within the service area for which the annual allocation was calculated, the annual allocation may then be subject to modification and reduction.
- 5 Permittee shall maintain an accurate flow meter at the intake of the water treatment plant for the purpose of measuring daily inflow of water.
- 6 All wells to be abandoned shall be abandoned in accordance with rule 40E-3, F.A.C., within sixty days of permit authorization.
- 7 Within six months of permit issuance, the Permittee shall implement the following saline water intrusion monitoring program:
- 8 Within two years of permit issuance, potable public water supply utilities are required to provide a study evaluating emergency water supply preparedness, including analysis of demand management measures, potential pumpage shifting and the feasibility of emergency interconnections for the purpose of supplying water on a short-term, emergency basis to adjoining utilities. The Permittee must provide the District with a copy of the study. As to emergency interconnects, the feasibility study must assess the technical, physical and economic ability of the Permittee to develop interconnecting pipes capable of delivering water to adjoining utilities to meet emergency, short-term water supply needs. (in the event of an interconnect being established, individual public water supply Permit allocations will not address the emergency usage.) It is the policy of the District to encourage emergency interconnects between adjoining public water supply utilities for the purpose of providing emergency water supply. Thus, where the feasibility study indicates emergency interconnects are possible, the District encourages the adjoining utilities to implement the same.
- 9 The Water Conservation Plan required by Section 2.6.1 of the Basis of Review for Water Use Permit Applications within the South Florida Water Management District, must be implemented in accordance with the approved implementation schedule.
- 10 In the event of a declared water shortage, water withdrawal reductions will be ordered by the District in accordance with the Water Shortage Plan, Chapter 40E-21, F.A.C. The Permittee is advised that during a water shortage, pumpage reports shall be submitted as required by Chapter 40E-21, F.A.C.
- 11 Source classification is:  
  
Ground Water from:  
Sandstone Aquifer

- 12 Permittee shall mitigate harm to existing legal uses caused by the permittee's withdrawals as determined through reference to the conditions for permit issuance. When harm occurs, or is imminent, the District will require the permittee to modify withdrawal rates or mitigate the harm. Harm, as determined through reference to the conditions for permit issuance, includes:
  - A) Reduction in surface or ground water levels that prevents an adjacent withdrawal facility from producing water, or
  - B) Induced movement of saline water or pollutants into a withdrawal facility to a degree that causes the water to be unsuitable for the use intended.
- 13 Permittee shall mitigate harm to existing off-site land uses caused by the permittee's withdrawals, as determined through reference to the conditions for permit issuance. When harm occurs, or is imminent, the District will require the permittee to modify withdrawal rates or mitigate the harm. Harm as determined through reference to the conditions for permit issuance, includes:
  - A) Significant reduction in water levels in an adjacent surface water body, including impoundments, to the extent that the designed function of the authorized structures and facilities is impaired,
  - B) Land collapse or subsidence caused by reduction in water levels, or
  - C) Damage to crops and other types of vegetation caused by withdrawals that impair the operation of a seepage irrigation system.
- 14 Authorized representatives of the District shall be permitted to enter, inspect, and observe the permitted system to determine compliance with special conditions.
- 15 If any condition of the permit is violated, the permit shall be subject to review and possible modification, enforcement action, or revocation.
- 16 Application for a permit modification may be made at any time.
- 17 Withdrawal facilities:
  - Ground Water – Existing:
    - 1 – 14" X 283' X 500 GPM Well Cased To 220 Feet
  - Ground Water – Proposed:
    - 1 – 14" X 290' X 350 GPM Well Cased To 200 Feet
- 18 This permit shall expire on November 13, 2007.
- 19 Annual allocation shall not exceed 117 MG.
  - Maximum daily allocation shall not exceed 0.9315 MG.
- 20 Water use classification:
  - Public water supply

- 21 The Permittee is advised that this permit does not relieve any person from the requirement to obtain all necessary federal, state, local and special district authorizations.
  - 22 The permit does not convey any property right to the Permittee, nor any rights and privileges other than those specified in the Permit and Chapter 40E-2, Florida Administrative Code.
  - 23 Permittee shall mitigate harm to the natural resources caused by the permittee's withdrawals, as determined through reference to the conditions for permit issuance. When harm occurs, or is imminent, the District will require the permittee to modify withdrawal rates or mitigate the harm. Harm, as determined through reference to the conditions for permit issuance includes:
    - A) Reduction in ground or surface water levels that results in harmful lateral movement of the fresh water/salt water interface,
    - B) Reduction in water levels that harm the hydroperiod of wetlands,
    - C) Significant reduction in water levels or hydroperiod in a naturally occurring water body such as a lake or pond,
    - D) Harmful movement of contaminants in violation of state water quality standards, or
    - E) Significant damage to the natural system including damage to habitat for rare or endangered species.
  - 24 Prior to withdrawing water as authorized by this Permit, the Permittee shall provide the results of the calibration testing of the identified water accounting method(s) and equip all existing and proposed withdrawal facilities with approved water use accounting method(s) pursuant to Section 4.1 of the Basis of Review for Water Use Permit Applications.
  - 25 Permittee shall submit all data as required by the implementation schedule for each of the limiting conditions to: S.F.W.M.D., Supervising Hydrogeologist – Post-Permit Compliance, Water Use Regulation Dept. (4320), P.O. Box 24680, West Palm Beach, FL 33416-4680.
- 101 .
- THE PERMITTEE SHALL MAINTAIN RECORDS OF THE CALIBRATED DAILY WITHDRAWALS FROM EACH PUMP. THESE RECORDS SHALL BE AVAILABLE FOR REVIEW UPON REQUEST BY DISTRICT STAFF. MONTHLY WITHDRAWALS FOR EACH PUMP SHALL BE SUBMITTED TO THE DISTRICT QUARTERLY. MAXIMUM DAILY WITHDRAWALS FOR EACH MONTH FOR THE ENTIRE SYSTEM SHALL BE SUBMITTED TO THE DISTRICT QUARTERLY. THE WATER ACCOUNTING METHOD AND MEANS OF CALIBRATION SHALL BE STATED ON EACH REPORT.

bc:Craig Boomgaard, P.G.  
ANNE MARIE SUPERCHI – 4320  
P. McGary – 4270  
Permit File  
Permit File – 4240  
S. Korf – 4270  
WU Compliance – T. Schwetje – 6861

#### ADDRESSES

Audubon of Florida  
Attn:  
1441 Gulf Coast Drive  
P.O. Box 11387  
Naples FL 34101-1387

Audubon of Florida Mr. Jason Lauritsen  
Attn: Mr. Jason Lauritsen  
375 Sanctuary Road  
Naples FL 34120

Dept of Environmental Protection – Ft. Myers  
Attn: – Ft. Myers  
P.O. Box 398  
Fort Myers FL 33902-0398

Div of Recreation and Park – District 4  
Attn: FDEP  
1843 S Tamiami Trail  
Osprey FL 34229

Div of Recreation and Park – District 8  
Attn: FDEP  
1843 S Tamiami Trail  
Osprey FL 34229

Engineer, City of LaBelle  
Attn: LaBelle  
PO Box 580  
LaBelle  
Labelle FL 33975

FDEP  
Attn:  
2295 Victoria Avenue  
Fort Myers FL 33901

Florida Fish & Wildlife Conservation Commission  
Attn: – Imperiled Species Mgmt Section  
620 S Meridian Street  
Tallahassee FL 32399-6000

**ADDRESSES**

Hendry County –Bd of County Comm (Mary Harn)  
Attn: –Bd of County Comm (Mary Harn)

Hendry County Engineer  
Attn: Shane Parker  
P.O.Box 1607  
La Belle FL 33975

S.W.F.R.P.C. Jim Beever  
Attn: Jim Beever  
1926 Victoria Avenue  
Fort Myers FL 33917

Tetra Tech  
Michael L Taylor P G  
,

Water Management Institute –Micahel N. Vanatta  
Attn: –Micahel N. Vanatta  
PO box 6446  
Vero Beach FL 32961

c: Audubon of Florida  
Dept of Environmental Protection  
Div of Recreation and Park – District 4  
Div of Recreation and Park – District 8  
Engineer, City of  
FDEP  
Florida Fish & Wildlife Conservation Commission  
Hendry County  
Hendry County Engineer  
S.W.F.R.P.C.  
Tetra Tech  
Water Management Institute

TABLE - A  
Description Of Wells.

Application Number: 080617-17

Well ID	26333	26334	223871
Name	PW-1	PW-2	South Well R
Map Designator	PW-1 (old South Well)	PW-2	SW (R)
FLUWID Number			
Well Field			
Existing/Proposed	E	E	P
Well Diameter(Inches)	8	14	14
Total Depth(feet)	300	283	290
Cased Depth(feet)	250	220	200
Facility Elev. (ft. NGVD)			
Screened Interval			
From	250	220	
To	300	283	
Pumped Or Flowing	P	P	P
Pump Type	turbine	turbine	submersible
Pump Int. Elev. Feet (NGVD)			
Feet (BLS)	0	0	190
Pump Capacity(GPM)	450	500	350
Year Drilled	1973	1983	2008
Planar Location Source	DIGITIZED	DIGITIZED	
Feet East	533779	533779	533834
Feet North	884334	884603	884334
Accounting Method	flow meter	flow meter	flow meter
Use Status	To be Plugged and Abandoned	Primary	Primary
Water Use Type	Public Water Supply Monitor	Public Water Supply Monitor	Public Water Supply
Aquifer	Sandstone Aquifer	Sandstone Aquifer	Sandstone Aquifer

Exhibit No 1

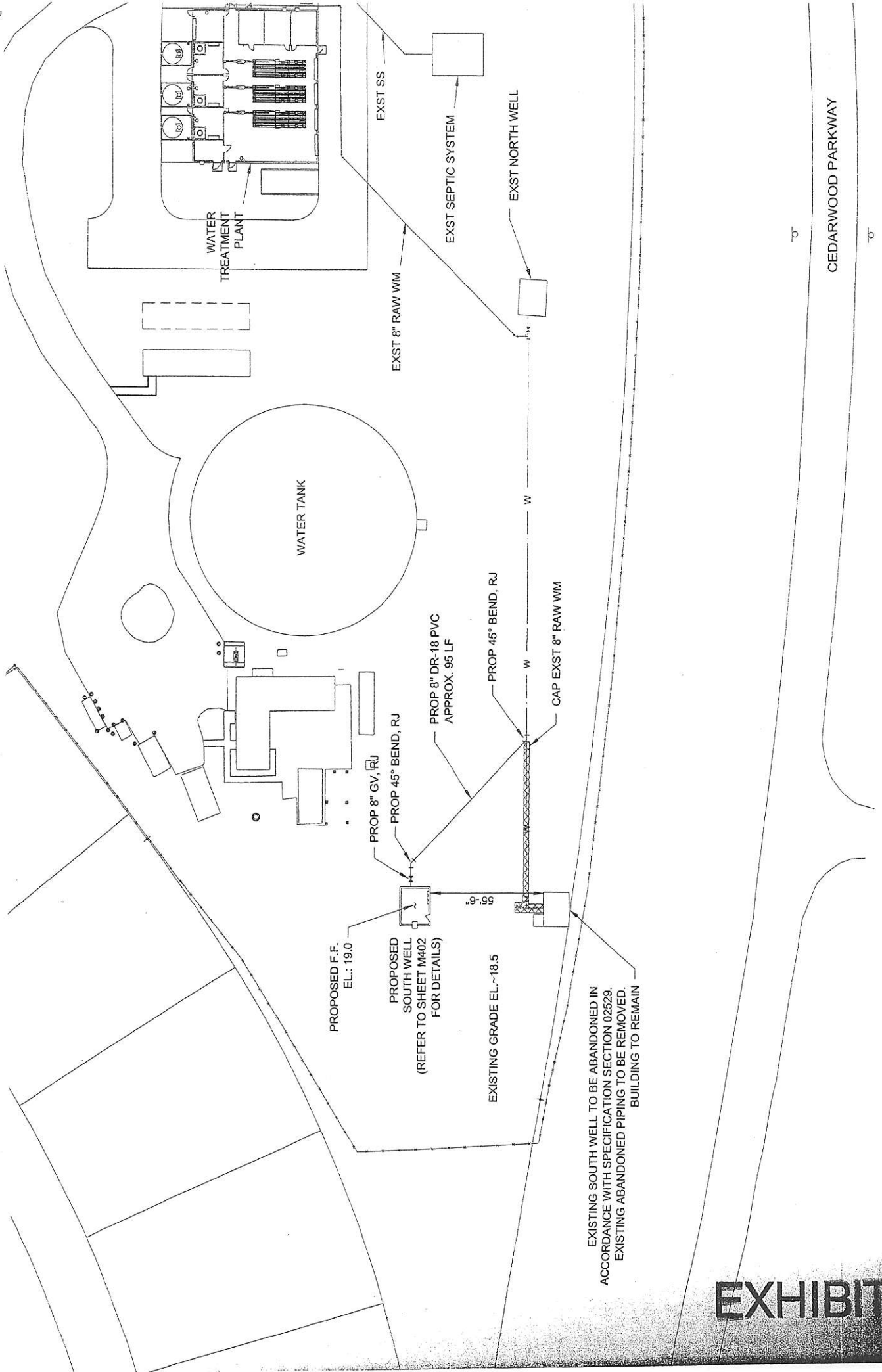

EXHIBIT 2